

Electric Construction Property Site Sketch and Liability Waiver



Customer Name: _____

Service Address: _____ City, State, Zip _____

Location Of Customer-Owned Facilities

All above ground and underground facilities must be clearly identified on your Property Site Sketch below.

Customer is required to indicate all that apply on the Property Site Sketch — see included EXAMPLE on Page 2.

- | | | | |
|--|---|--|---|
| <ul style="list-style-type: none"> • Desired electric meter location <u>with footages</u> from nearest corner of the building (Indicate E). • External wood furnaces and associated buried heating lines • Geothermal heat pumps with connecting lines to buildings | <ul style="list-style-type: none"> • Wells and private water lines including underground sprinkler systems with connecting lines to buildings. • Drain tile/buried down spout and sump pump lines • Planned or potential deck, patio, swimming pools or outbuildings | <ul style="list-style-type: none"> • Municipal sewer/water laterals • Septic systems/drain fields with connecting lines to buildings • Air conditioning units and all fresh air intakes • Existing and future landscaping features
IE : Landscape berms or retaining walls | <ul style="list-style-type: none"> • LP fuel lines/tanks with connecting lines to buildings • Invisible Fences • Private underground wiring • Private cable/satellite TV Lines • Other |
|--|---|--|---|

If no existing or future proposed private facilities on the property check here



At the time of construction, all existing or proposed private underground facilities must be marked or exposed before service can be installed.

Construction Authorization / Underground Damage Liability Waiver:

I certify that I own or am the authorized representative of the owner of the property of the service address indicated on this Property Site sketch, and that I have read and understood the above statement regarding marking and / or exposing all private underground facilities. I furthermore agree to hold Upper Peninsula Power Company and/or its agents harmless for any damage to private underground facilities that occurs during the installation of gas or electric service as a result of failure on my part to ensure that the private underground facilities on this property have been adequately marked and / or exposed.

Signature: _____ Date: ____/____/____

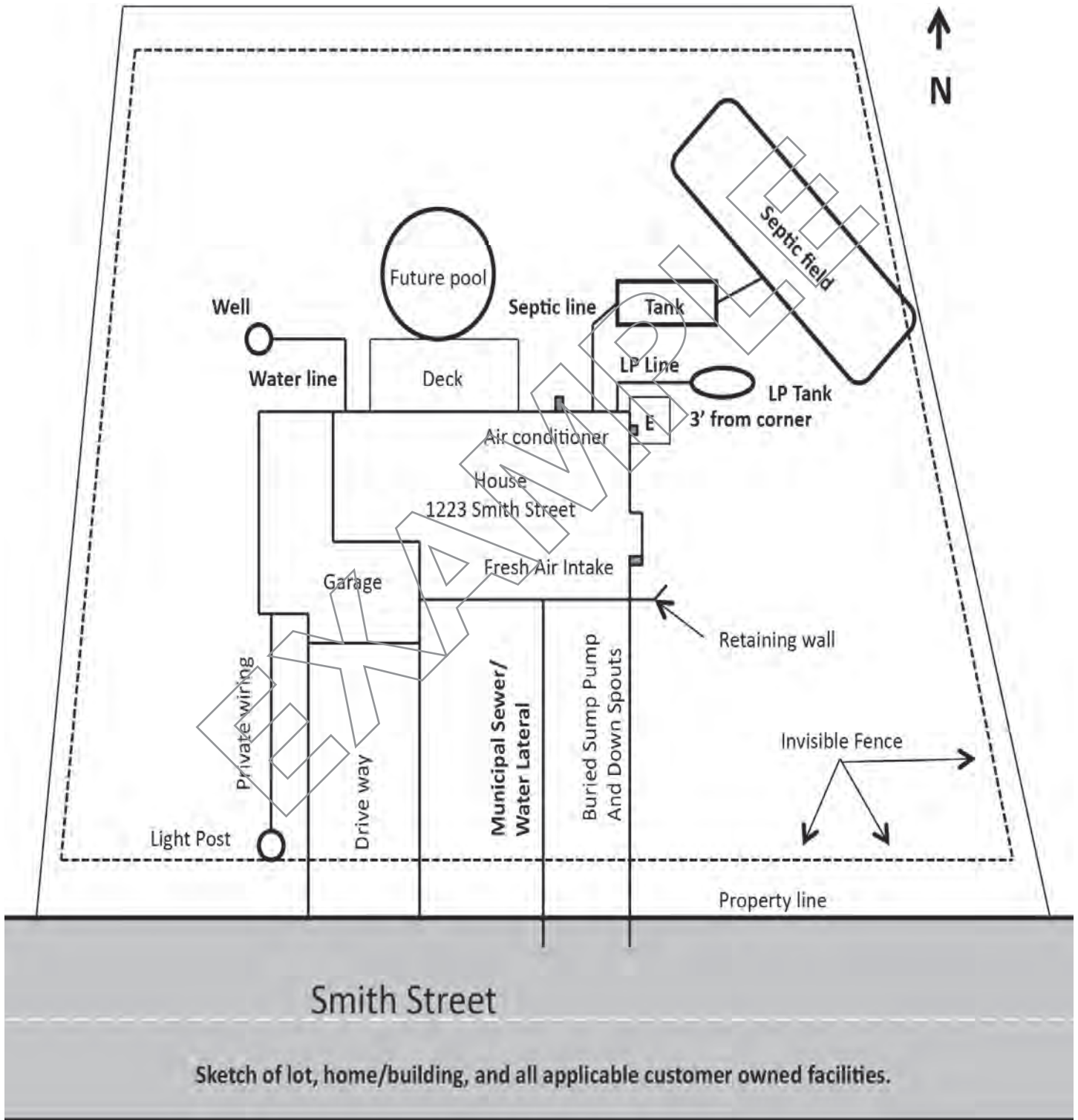

Please complete and return this form to:

Upper Peninsula Power Company • Customer Contact Center • 500 N. Washington St., Ishpeming, MI 49849

Residential Service: Phone: 800-562-7680 • Fax: 906-485-2431 • Email: customerservice@upppo.com

Business Service: Phone: 800-337-8445 • Fax: 906-485-2431 • Email: customerservice@upppo.com

Website: www.upppo.com