



Commercial or Industrial Electric Service Application

Instructions: Please complete and return this application after your contractor(s) have been selected.

Submit the application and load survey forms to: Upper Peninsula Power Company – Attention: Customer Contact Center

- E-mail: customerservice@uppcoco.com
- Fax: 906-485-2431
- Mail: 500 N. Washington St., Ishpeming, MI 49849

Submit the final approved electronic site plan (in AutoCAD and Microstart format) and your construction plans (in PDF format) to:

- E-mail: customerservice@uppcoco.com

Questions: Call 800-337-8445 or visit our website at www.uppcoco.com TODAY'S DATE: _____

TYPE OF SERVICE REQUESTED: (check all that apply)

- New Service Upgrade Relocate Temporary Electric Private Yard Light

BILLING AND CONTACT INFORMATION:

PARTY RESPONSIBLE FOR CONSTRUCTION CHARGES: Customer Contractor

PARTY SUBMITTING THIS REQUEST: Customer Contractor

CUSTOMER INFORMATION:

Legal Business Name: _____ Tax ID #: _____

OR

Personal Name (Sole Proprietorship): _____ Social Security #: _____

D/B/A Name: _____ Contact: _____

Work #: _____ Cell #: _____ Fax #: _____ Email: _____

Mailing Address: _____

Street/P.O. Box City State Zip Code

CONTRACTOR INFORMATION:

Legal Business Name: _____ Tax ID #: _____

Contact: _____

Work #: _____ Cell #: _____ Fax #: _____ Email: _____

Mailing Address: _____

Street/P.O. Box City State Zip Code

SITE INFORMATION:

Street Address: _____ Lot #: _____

Town/City/Village: _____ County: _____

State: _____ Zip Code: _____

Nearest Neighbor or Nearest Utility Pole #: _____

Directions from the Nearest Intersection: _____

STRUCTURE INFORMATION:

Setback from Edge of Road: _____ ft. Building Square Footage: _____

Building Type: (check one) Commercial Agricultural
Building Energy Use: (check one) Year-round Seasonal
Construction Type: (check one) Cold Storage Irrigation Manufacturing Office
 Restaurant Multi Unit Commercial* Warehouse
 Retail Multi Family* Other: _____

*If Multi Family or Multi Unit Commercial building, please provide labeling (i.e., suites, apts, units 1, 2, 3... or A, B, C):

Total # Electric Meters: _____

ELECTRIC INFORMATION:

Electrical Contractor: _____ Contact: _____

Work #: _____ Cell #: _____ Fax #: _____ Email: _____

Electrical Service Type: Overhead Underground

Entrance Size: 200 400 600 800 1200 Other: _____

Phase: Single Phase (120/240) Three Phase (120/208) Three Phase (277/480)

Please complete and submit the attached Electric Load Survey form

Preferred Meter Location: (i.e., 3 ft. back from NW corner): _____

Temporary Service Needed: Yes No Amps: _____ Voltage: _____

Date temporary will be ready for service: _____

Preferred temporary meter location: _____

PRESENT STATUS OF BUILDING PROJECT: (check all that apply)

Property is staked Yes If not, when? _____ Site has been excavated Yes If not, when? _____

Building is staked Yes If not, when? _____ Meter base installed Yes If not, when? _____

SERVICE READY DATE: (date that initiates scheduling of service installation)

DATE SITE WILL BE READY FOR SERVICE: _____

PLEASE NOTE: The following requirements must be completed before service can be installed.

- Final approved site plan and construction plans submitted.
- Electric load survey submitted.
- Any required easements signed and submitted.
- The site and foundation must be back-filled within 6" of final grade.
- The service route cleared 10' wide.
- The electric metering equipment must be installed.

- If a cement transformer pad was poured, must be cured for 10 days.

- Any underground private facilities must be marked.
- Construction charges must be paid in advance if applicable.

Other Important Details:

- UPPCO also requires an electrical inspection (check with your municipality) prior to energizing the service.
- Winter Construction Charges may apply.

Electric Construction Property Site Sketch and Liability Waiver



Customer Name: _____

Service Address: _____ City, State, Zip _____

Location Of Customer-Owned Facilities

All above ground and underground facilities must be clearly identified on your Property Site Sketch below.

Customer is required to indicate all that apply on the Property Site Sketch — see included EXAMPLE on Page 2.

- | | | | |
|--|---|--|---|
| <ul style="list-style-type: none"> • Desired electric meter location <u>with footages</u> from nearest corner of the building (Indicate E). • External wood furnaces and associated buried heating lines • Geothermal heat pumps with connecting lines to buildings | <ul style="list-style-type: none"> • Wells and private water lines including underground sprinkler systems with connecting lines to buildings. • Drain tile/buried down spout and sump pump lines • Planned or potential deck, patio, swimming pools or outbuildings | <ul style="list-style-type: none"> • Municipal sewer/water laterals • Septic systems/drain fields with connecting lines to buildings • Air conditioning units and all fresh air intakes • Existing and future landscaping features
IE : Landscape berms or retaining walls | <ul style="list-style-type: none"> • LP fuel lines/tanks with connecting lines to buildings • Invisible Fences • Private underground wiring • Private cable/satellite TV Lines • Other |
|--|---|--|---|

If no existing or future proposed private facilities on the property check here



At the time of construction, all existing or proposed private underground facilities must be marked or exposed before service can be installed.

Construction Authorization / Underground Damage Liability Waiver:

I certify that I own or am the authorized representative of the owner of the property of the service address indicated on this Property Site sketch, and that I have read and understood the above statement regarding marking and / or exposing all private underground facilities. I furthermore agree to hold Upper Peninsula Power Company and/or its agents harmless for any damage to private underground facilities that occurs during the installation of gas or electric service as a result of failure on my part to ensure that the private underground facilities on this property have been adequately marked and / or exposed.

Signature: _____ Date: ____/____/____

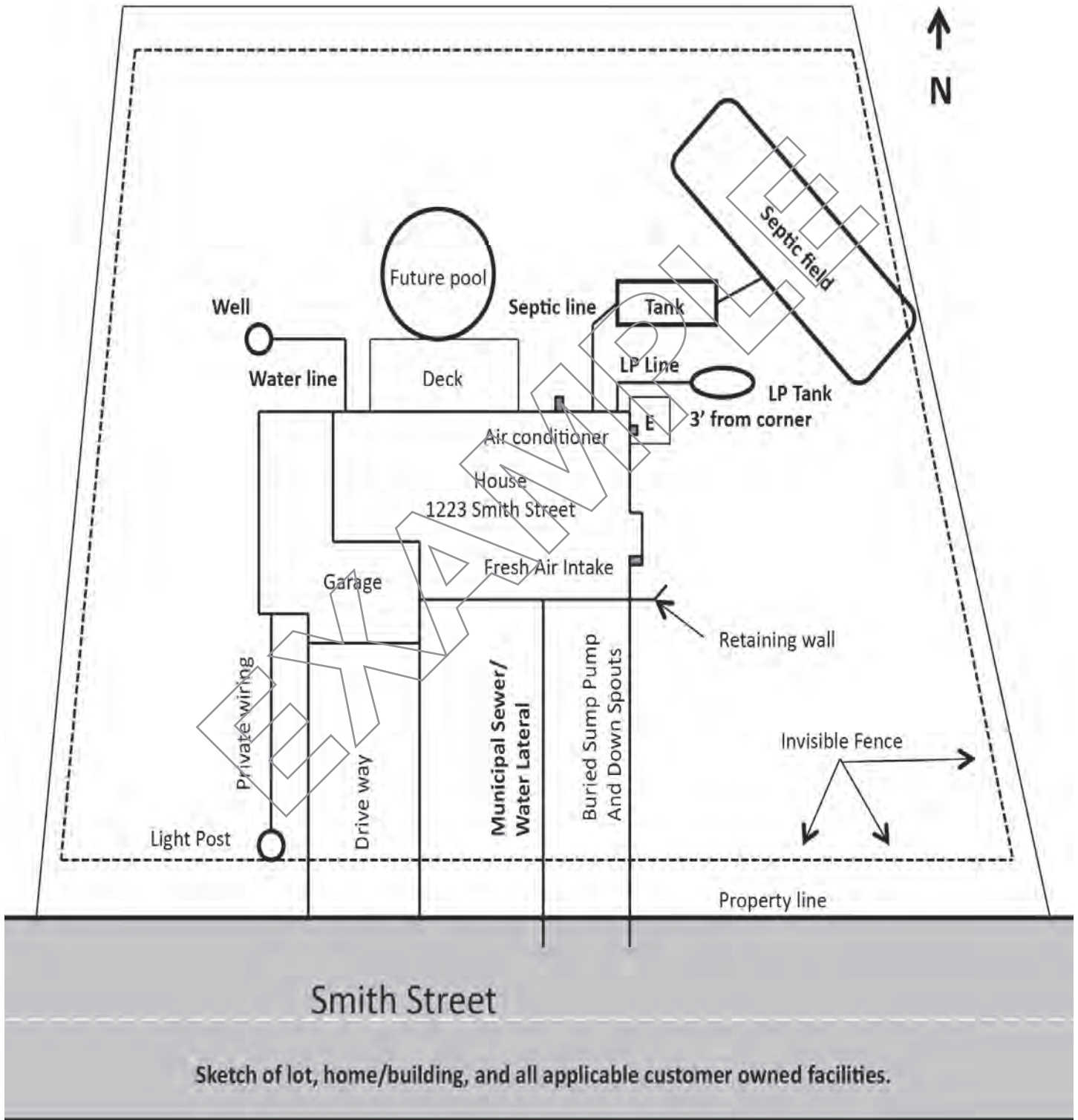

Please complete and return this form to:

Upper Peninsula Power Company • Customer Contact Center • 500 N Washington St, Ishpeming MI 49849

Residential Service: Phone: 800-562-7680 • Fax: 906-485-2431 • Email: customerservice@upppo.com

Business Service: Phone: 800-337-8445 • Fax: 906-485-2431 • Email: customerservice@upppo.com

Website: www.upppo.com



Upper Peninsula Power Company

Upper Peninsula Power Company Electric Load Data Form

Please be as specific as possible.

UPPCO Work Request # (if known): _____

Company Providing Data: _____ Contact Person/Title: _____

Preferred Contact Method(s):

Phone # : _____ E-mail Address: _____

Project Street Address & City: _____

(Please provide a separate form for each address)

Number of Meters at this Address: _____ Unit Labeling: _____

(i.e. Suites 300-308, Apts. 101-130, Units 1-4, or A, B, C)

Business Type: _____ Days & Hours of Operation: _____

(i.e. M – F, 8:00am - 5:00pm)

Type of Service: (Check one) New Customer Existing Customer

New Service Size (Amps): 100 200 400 600 800 1200 1600 2000 Bldg. Sq. Ft. _____

New Service Type: Underground Overhead CT Metering Location (If applicable): On Transformer On Building

New Voltage: Single Phase 120/240 Three Phase 120/208 Three Phase 277/480

IF UPGRADING - Existing Service Type: _____ Existing Service Size (Amps): _____ Existing Voltage: _____

MOTOR LOAD: (Please list all motors that are 5 HP or greater separately. Motors less than 5 HP can be grouped together)

Equipment Description	# of Motors	Size of Motors (HP)	1 or 3 Phase	Soft Start / Variable Frequency Drive

ELECTRIC LOAD: (Other load may include: Computers, kitchen equipment, water heating, supplemental heating, etc.)

Description	KW	1 or 3 Phase
Lighting (indoor)		
Lighting (outdoor)		
Air Conditioning		
Ventilation (other than A/C)		
Refrigeration Equipment		
Receptacles		

WELDERS:

# of Welders	Amps	Volts

PLEASE ATTACH ANY OTHER SUPPORTING DOCUMENTATION WHEN SUBMITTING THIS LOAD DATA

Return to: Upper Peninsula Power Company – Attention Customer Service

- Mail: 500 N Washington St, Ishpeming MI
- Fax: (906) 485-2431
- E-mail: customerservice@uppc.com

Questions: Call (906) 449-2014 / (800) 337-8445 or visit our website at www.uppc.com